

Worksman Stretch Mover™ Industrial Tricycle Owner's Manual

Models M2620-CB-STR, M2620-3CB-STR_

Parts list M2620-STR-08

Worksman Stretch Mover™

Congratulations! You have purchased an American Made Worksman Stretch Mover™ Industrial Tricycle. The Mover™ is considered the flagship of the Worksman Business Cycle System, which is undoubtedly the finest line of industrial cycles on Earth. The Stretch Mover is the newest addition to the Worksman Mover™ lineup. These durable tricycles are used around the world by leading companies and organizations to move personnel and supplies efficiently, safely and in an environmentally friendly manner. The Stretch Mover™ is the next Worksman Classic.



Before assembly and riding, make certain to read this manual and any other literature provided thoroughly. Always follow the rules of safe riding. Always keep your Mover™ Tricycle in tip-top shape by replacing worn parts as needed with Genuine Worksman Cycles parts (do not use generic bicycle parts). With simple maintenance, your Worksman Mover Tricycle will perform reliably day after day, year after year, decade after decade.

Your Stretch Mover™ Tricycle has been hand-made in the USA by our American craftspeople. Our reputation rides along with you, so your ultimate satisfaction is our goal.

Worksman Mover™ Parts List M2620-STR-08

Part #s and Specifications subject to change without notice as we are constantly seeking ways to improve our products. Worksman Cycles recommends having your new tricycle professionally assembled. Failure to do so could result in injury or death.

Frame, Fork and Related Parts

| <u>Part #</u> | <u>Description</u> | <u>Part #</u> | <u>Description</u> |
|---------------|---|---------------|-----------------------------------|
| MF2620STRA | Mover Stretch Frame Only- Specify color | 60HD | Fork-Color Black |
| 60HD-YEL | Fork- Color Safety Yellow | 60HD-ORG | Fork-Safety Orange |
| 60HD-SP | Fork (other color- please specify) | 48 | Head Set Cups (pair) |
| 49 | Headset Bearings (pair) | 50A | Headset Complete (48,49,52,53,54) |
| 51 | Bottom Cone (presses on Fork) | 52 | Top Adjusting Cone (threaded) |
| 53 | Key Washer | 54 | Fork Top Lock nut |
| 55F | Handlebar-Junior High Rise | 55A | Stem for Handlebar |
| 55B | Hand Grips (pair) | 3927STPT | Rear Platform 38x26+ |
| 4921 | Rear Leaf Springs (each) | 4926 | U-Bolts (to attach springs) |

Front Wheel (26+) and Related Parts

| <u>Part #</u> | <u>Description</u> | <u>Part #</u> | <u>Description</u> |
|---------------|--|---------------|---|
| 77A | Front Wheel w/Drum Brake w/o tire | 77 | Front Wheel w/Drum Brake w/air tire |
| 77S | Front Wheel w/Drum Brake- Solid Tire | L900 | Drum Brake-Hub Only |
| L709 | Front Axle Set for Drum Brake | F817 | Bearings-Loose 11 balls |
| L752R | Brake Lever w/ Parking Lock- Right Hand) | L752L | Brake Lever w/ Parking Lock- Left |
| F769 | Anchor Bolt Assembly for F719 Cable | F770 | Adjusting Barrel For F719 Cable |
| F719 | Front Drum Brake Cable and Casing (includes Adjusting Barrel and Anchor Bolt) | L725 | Drum Brake Plate Kit (Internal parts kit -Shoes, Plate, Lever and Cam) |



Rear Axle and Related Parts

| <u>Part #</u> | <u>Description</u> | <u>Part #</u> | <u>Description</u> |
|---------------|---|---------------|---------------------------------------|
| 102 | Key Washer | 105 | Adjusting Cone (threaded) |
| 106 | Stationary Cone (presses onto axle) | 109 | Dust Washer |
| 113 | Locknut - Left Hand Thread - Free Wheel Side | 146 | Bearings (pair) |
| 59M | Locknut - Drive Side | 64M | Woodruff Key for Drive Wheel |
| 132 | Axle Parts Set(102,105,109,113,146,59M) | M13967 | Rear Axle 36+ |
| 69 | Fixed Drive Sprocket (for rear axle) | 63B | Set screw for 69 |
| 63C | Key (fits in axle slot to attach rear sprocket) | M13975 | Side Bearing with Plate (each) |
| M13974 | Center Axle Support Bearing | 301M | Coaster Brake w/Dual Sprockets |
| 404NM | 3 Speed Coaster Brake w/dual Sprockets | SS721 | Coaster Brake Internal Kit (for 301M) |
| SS13N-3 | 3 Speed Cable and Trigger for 404NM | 4921 | Springs and parts U-BOLTS |
| 4926 | U-Bolts for Leaf Springs | | |

Crank and Crank Parts (Pedal Section) and Chains

| <u>Part #</u> | <u>Description</u> | <u>Part #</u> | <u>Description</u> |
|---------------|--|---------------|---|
| 1265 | Crank Parts (1266,1268,1269,1271,1272,1273,1274) | 1265BMXS | Deluxe Sealed Crank Set (Upgrade) |
| 1266 | Crank Bearings (pair) | 1267 | Complete Crank Set 36T(1265,1275,1380D) |
| 1267F | Complete Crank Set with 32 T Sprocket | 1267H | Complete Crank Set w/ 28T Sprocket |

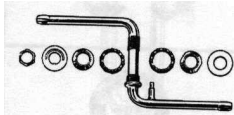

Note- The Stretch Mover Comes standard with a 32T front Sprocket and 1265 Crank part set. Smaller sprockets in the front will reduce gear ratio (easier to start pedaling). The 1265BMXS is a heavier duty upgrade for crank parts. 1275 crank with 1265 hanger parts etc. shown (left.)

| | | | |
|-----------|---------------------------------------|--------|-------------------------------------|
| 1268 | Cups for crank housing (pair) | 1269 | Stationary washer(inside) |
| 1271 | Key Washer- Outside | 1271 | Key Washer- Outside |
| 1272 | Adjusting Cone (threaded)-Outside | 1273 | Stationary Cone- Inside |
| 1274 | Crank Locknut | 1275 | Crank-forged- 6.5+ |
| 1380F | Sprocket 32Tooth | | |
| 1380H | Sprocket 28 Tooth | 7217 | Pedal Set (Pair) |
| 4910A | Chainguard | 4914A | Chain Connecting Link(1/2x3/16+) |
| 4914STR32 | Chain 1/2x3/16x187 (for 32T Sprocket) | 4914XX | Chain- Short 3 1/2x3/16x37 |
| 4914STR28 | Chain 1/2x3/16x185 (for 28T Sprocket) | 4915 | Chain Adjusters (for Coaster Brake) |

Seats and Seatpost and Fenders, Baskets and Cabinets

| <u>Part #</u> | <u>Description</u> | <u>Part #</u> | <u>Description</u> |
|---------------|--|---------------|---------------------------------------|
| 6910V-5 | Saddle-padded w/5/8+clamp (standard) | 6911V-5 | Saddle-padded w/springs & 5/8+Clamp |
| MSF2620-STR | Side Fender Set (M2620-CB-STR) | 4908D | Seatpost |
| M13970 | Basket fits Rear Platform- 23x22x15+Heavy Duty | 3927STPT | Rear Platform 38x26+w 3+Lip-Standard |
| M17350 | Cabinet-23x22x11.5+fits on Rear Platform | M17350J | Jumbo Cabinet 23x22x20+ |
| 3927SUD | Jumbo Cabinet - Replaces Platform (42x23x26+) | 7228 | Front Basket 21x15x9+w/bracket |
| 139 | Front Basket 18x13x6+w/bracket | 82 | Front Fender-26+ |
| 83A | Brace- Front Fender | 95 | Washer Bracket (Front Fender to Fork) |
| 4906 | Bolt Set for bottom of M13996 | 4907 | Bolts, nut, washer (for 83A Brace) |
| 4905 | Bolt set for attaching 4902 to top of M13996 | 4907A | Bolt Set to attach 82 to Fork |



6911V-5 Saddle
Thickly Padded



7228 Front Basket
21x15x9+



Wheels , Tires and Fenders

Parts List M2620-STR08

| <u>Part #</u> | <u>Description</u> | <u>Part #</u> | <u>Description</u> |
|---------------|--|---------------|---|
| 77A | Front Wheel w/ Drum Brake w/o Tire | 77 | Front Wheel w/ Drum Brake w/ Air Tire |
| 77S | Front Wheel w/ Drum Brake w/Solid Tire | 77KVPVR | Front Wheel w/ Drum Brake w/ Kevlar Tire |
| 1008A | Wheel 20+Free Side w/o Tire | 8132SA | Wheel 20+Free Side- Welded Mag w/o Tire |
| 1008 | Wheel 20+Free Side w/Air Tire | 8132 | Wheel 20+Free Side- Welded Mag w/Air |
| 1008S | Wheel 20+Free Side w/Solid Tire | 8132S | Wheel 20+Free Side- Welded Mag w Solid |
| 1008KVPVR | Wheel 20+Free Side w/ Kevlar Air Tire | 8132KVPVR | Wheel 20+Free Side- Welded Mag w/Kevlar |
| M14022 | 20+Drive Side Wheel w/o Tire | 8133MSA | 20+Drive Side Mag Welded w/o Tire |
| M14023 | 20+Drive Side Wheel w/ Air Tire | 8133M | 20+Drive Side Mag Welded w/ Air tire |
| M14024 | 20+Drive Side Wheel w/Solid Tire | 8133MS | 20+Drive Side Mag Welded w/ Solid tire |
| M14023KVPVR | 20+Drive Side Wheel w/ Kevlar Air Tire | 8133MKVPVR | 20+Drive Side Mag Welded w/ Kevlar tire |
| 4922A | Tire- 26x2.125 WTC Sup-r-Tire | 4922AKV | Tire-26x2.125 WTC KEVLAR Sup-r-Tire |
| 4939 | Tire-Solid Rubber Nev-R-Fail 26+ | 4922AWSW | Tire-26x2.125 Sup-r-Tire- White Wall |
| 4923A | Tube 26x2.125 (front-standard) | 6023A | Tube- Thorn Resistant 26x2.125 |
| 1017 | Rim Strip 26+ | 4922 | Tire-20x2.125 Sup-r-Tire (standard) |
| 4922KV | Tire 20x2.125 WTC - Kevlar Sup-r-Tire | 4938A | Tire- Solid Rubber Nev-R-Fail 20+ |
| 4923 | Tube-20x2.125 | 6023 | Tube- Thorn resistant 20x2.125 |
| 1017A | Rim Strip 20+ | 101 | Hub for free side Wheel |
| 3980 | Hub for Drive Side Wheel | 1016 | Rim Only 26+(no spokes- outer rim only) |
| 1015 | Rim Only 20+(no spokes-outer rim Only) | 1014E* | Spoke for side wheels 11 G 7 3/16+ |
| 1014D* | Spoke for 26+Drum Wheel 11G- 9 9/16+ | | <i>*note- spokes sold in bags of 36 and include nipples</i> |

NOTE- WORKSMAN MOVER TRICYCLES COME STANDARD WITH WTC CLINCHER WHEELS W/ 11 G SPOKES. THEY ARE VERY DURABLE. THE WELDED MAG STYLE WHEELS ARE AVAILABLE ONLY FOR THE SIDE WHEELS. KEVLAR TIRES ARE BELTED AIR TIRES- IDEAL FOR PREVENTING FLATS. NEV-R-FAIL SOLID TIRES ARE SOLID RUBBER- NO FLATS! REAR RIGHT WHEEL IS DRIVE SIDE, LEFT IS FREE SIDE.

Safety and Comfort Accessories

| <u>Part #</u> | <u>Description</u> | <u>Part #</u> | <u>Description</u> |
|---------------|---------------------------------------|---------------|--------------------------------------|
| 3979 | Ding Dong Chime Bell | 303 | Squeeze Bulb Horn |
| 3973 | Mega-Horn- Battery Operated- LOUD | 201 | Cable and Lock (set) |
| 4963 | Rear View Mirror | 5030T | Reflector Set with Mounting Hardware |
| 3978 | Safety Flag on Pole | P19 | Bicycle Helmet |
| P101710 | Flashing Strobe Slight (Clear Lens) | P101714 | Flashing Strobe Light (Red Lens) |
| 7217-41197 | Pedals with Velcro Foot Straps (Pair) | 3975 | Generator Light Set |
| 1006 | Air Pump for Tire Inflation (Manual) | 1000 | Spoke Tightening Tool |
| 2000 | Chain Rivet Remover Tool | 1265TW | Crank Cone Wrench |
| 1001 | Pedal Wrench | Trailer | Heavy Hauler Trailer |



Accessorize your Worksman Business Cycles: Shown- Worksman ADC-CB Tricycle with Heavy Haul Trailer, Welded Mag Rear Wheels, Nev-r-Fail Solid Tires, Mega Horn, M13970 basket on Trailer, Ding Dong Bell, Bulb Horn, Mirror and Safety Flag.

Worksman Cycles are available in many styles, 11 attractive colors and with a wide selection of options. Replacement parts are readily available so your American Made Worksman Business Cycle will never let you down!

Worksman Cycles.....Unmatched Quality-----Incredibly Selection-----Unmatched Enduring Value



Worksman PAV



Worksman Team Dual Tricycle



No Fuel, No Fumes

Stretch Mover™ M2620-CB-STR

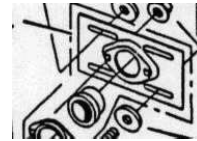
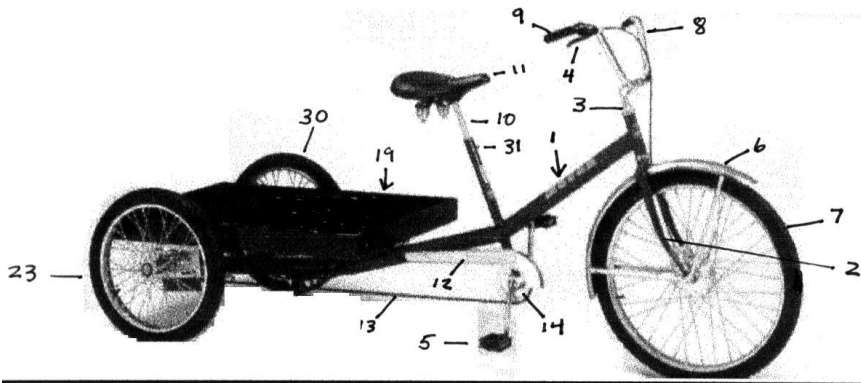

#22 M13975 Side Bearing with Plate

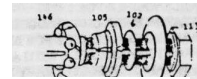

#28 132 Axle Parts Set



#24 69 Fixed Drive Gear

#25 58 Axle

#22 M13975 Side Bearing

| | | | <u>Key #</u> | <u>Part #</u> | <u>Description</u> |
|----|---------------|------------------------------------|--------------|---------------|----------------------------------|
| 1 | MF2620STRA | Frame | | | |
| 2 | 60HD | Fork | | | |
| 3 | 55A | Stem for Handlebar | 22 | M13975 | Outer Bearing Assembly for axle |
| 4 | L752L / L752R | Brake Hand Lever (Left / Right) | 23 | M14022 | Wheel-Drive Side 20+w/o tire |
| 5 | 7217 | Pedal Set | or | 8133MA | Wheel- Mag- Welded |
| 6 | 82 | Front Fender | 24 | 69 | Fixed Drive Sprocket - Rear Axle |
| 7 | 77A* | Front Wheel w/Drum Brake | 25 | M13967 | Rear Axle 34+ |
| 8 | 55F | Handlebar | 26 | M13970 | Steel Basket for Rear Platform** |
| 9 | 55B | Hand Grips (pair) | 27 | M17350 | Rear Cabinet*** |
| 10 | 4908D | Seatpost | 30 | 1008A* | Wheel- Free Side 20+w/o tire |
| 11 | 6910V-5 | Saddle (6911V-5 is w/ springs) | 31 | 4909M | Bolt- Square Head for Seatpost |
| 12 | 4910A | Chainguard | | | |
| 13 | 4914STR32 | Chain-Long(1/2x3/16x187) | | | |
| 14 | 1267F | Sprocket & Crank Set 32T | | | |
| 17 | 4914XX | Chain Short (1/2x3/16x27) | | | |
| 18 | 301M or 404NM | Coaster Brake /or/ 3 Speed Coaster | | | |
| 19 | 3927STPT | Rear Platform 38x26x3+ | | | |

M13970 Basket

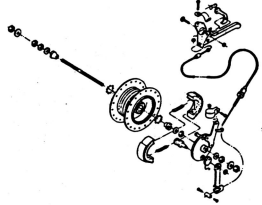

#29-Exploded view of L900

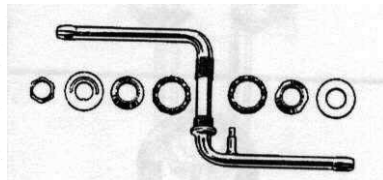

1275 Crank & 1265 Hanger Parts Set

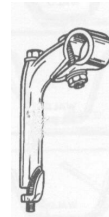

55A Stem

*WHEELS LISTED ABOVE ARE WITHOUT TIRES. REFER TO THE WHEEL SECTION TO IDENTIFY PART #'S FOR WHEELS WITH EITHER AIR TIRES OR SOLID TIRES.
 ** REAR PLATFORM IS 38X26+WITH 3+LIP. BASKET IS 23X23X16 AND CAN BE MOUNTED ONTO PLATFORM, LEAVING EXTRA PLATFORM SPACE AROUND BASKET
 *** REAR CABINETS ARE AVAILABLE IN 4 SIZES: 3927 (22X15X16+), M17350 (22X22X11+), M17350J (22X22X18+, OR 3927T 42X23X26+(REPLACES PLATFORM)





Assembly Instructions for The Worksman Stretch Mover™ Industrial Tricycle:

Congratulations! You have purchased one of the most unique, useful, practical industrial cycles ever made. The Worksman Stretch Mover is the latest member of the Worksman Business Cycle System. Your Worksman Stretch Mover™ Industrial Tricycle has been hand made by American Craftspeople at our Ozone Park New York City Factory. We take great pride in each and every Worksman Business Cycle that we manufacture and appreciate your support. Please read this manual carefully prior to performing the simple finishing assembly and prior to riding. Keep these instructions as our parts list is contained within this document which you will need for future reference.

Carefully remove the tricycle from the carton. You will notice the Stretch Mover tricycle is mostly pre-assembled at the factory. Some finishing assembly is required.

INSTALLING PEDALS:

Pedals are marked on the shaft with either an “L” or “R” denoting left or right. The “R” pedal fits on the right sprocket side of the crank arm. Tighten clockwise. The “L” pedal fits on the left side of the crank arm. Tighten counter clockwise (left hand thread). Securely tighten. Recommended torque 275 IN. LBS. **CAUTION:** tightening in the wrong direction will damage the crank and pedal threads.

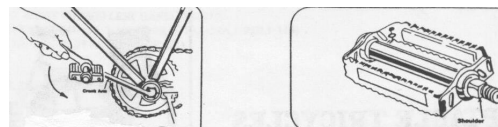

ATTACH FRONT FORK:

Grease cups (48) using Rustolene 200 lubricant or equal. Bearings (49) are pre-greased at the factory, but it is always a good idea to add lubrication prior to assembly.

- 1) Place one bearing (#49) onto the fork steering tube with the balls facing up.
- 2) Slide the threaded fork (50HD) steering tube into the frame head
- 3) Place the other bearing on the top of the fork tube with the balls facing down towards the cup (#48), which is already pressed onto the frame.
- 5) Install the top adjusting cone (#52) onto the treaded fork steering tube. Hand tighten, making certain the bearings do not bind. After hand tightening, turn back ¼ turn.
- 6) Install the fork key washer (#53) and reflector bracket (if reflectors were ordered) on top of the adjusting cone with tip of washer in slot on steering tube.
- 7) Install head lock nut (#54) and securely tighten. Make sure that the fork rotates freely without being loose. Excess play or resistance must be adjusted. Failure to adjust properly can lead to improper steering response.

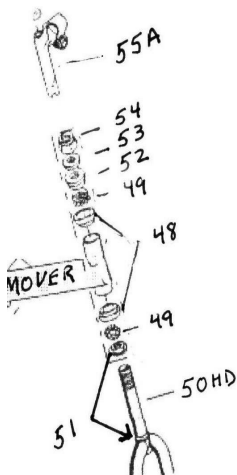

Please familiarize yourself with the features of your new cycle prior to riding. Read Rules for Safe Riding and make certain that you are familiar with the brakes prior to riding. Always Place cargo securely on the rear platform to make certain that items will not shift or fall during operation of cycle. Use Tie-Down straps when necessary.

SEAT ADJUSTMENTS:

Although the seat is already installed at the factory, adjust the height to your desired level by loosening the seat clamp nut. Re-tighten at desired height. Make sure a minimum of 3 1/2+ of the post remain in the frame tube. (Look for minimum insertion line.) Never adjust post above this level. Adjust angle of seat with nose raised slightly. Tighten seat clamp under the seat securely. (240 IN. LBS.).

HANDLEBAR ADJUSTMENT:

Install handlebar stem (55A) into the fork steering tube with the handlebar clamp facing forward. The stem must be inserted far enough to reach the minimum insertion line. Tighten the stem bolt slightly at this point. Loosen the handlebar clamp nut and slide the handlebar through the clamp centering the knurled center section of the handlebar into the clamp. Position the handlebar to the desired angle and tighten clamp securely. Recommended torque is 300 IN. LBS. Adjust the handlebar rotation so that it is perpendicular to the front wheel when it is perfectly straight. Tighten stem bolt securely. Recommended torque 240 IN. LBS. Be sure not to over tighten as damage to the parts may occur causing steering failure.



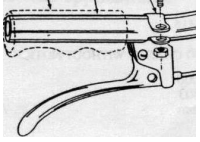

Attach brake hand lever to the handlebar (either left or right depending upon the rider's preference.) Make sure brake cable is not tangled in anyway.

ONLY USE GENUINE WORKSMAN CYCLES REPLACEMENT PARTS

Helpful Maintenance Tips:

Always inspect your Worksmen Cycle to insure that that all nuts, bolts, screws and hardware are tight and that no parts are worn or damaged. Do not attempt to straighten bent forks or frames.

Chain: Lubricate chain every six months or as needed with light oil. Replace sprockets when teeth become worn, bent or broken. Keep chain adjusted so there is no more than 3/8" slack. Note, we make the chains tight at the factory as we do know they will stretch during the break-in period.



Lubricate crank parts as needed and replace pedals when the surface is worn or if pedal axle becomes tight or frozen.

Drum Brake: Your Worksmen Mover Tricycle is equipped with an automotive type front drum brake. This brake is ideal for slowing your vehicle smoothly and reliably. It is engaged by squeezing the hand lever on the handlebar. To use Park+ feature, when cycle is completely stopped, squeeze hand lever and push in parking plunger button on lever. To disengage, simply squeeze lever until parking plunger button releases. Drum Brakes are pre-adjusted at the factory. Readjust the cable tension as necessary using the adjusting barrel so that wheel spins freely and stops when brake is applied. Always replace worn brake cables (F719) and damaged hand levers. Internal parts are available for your Drum Brake (L725 parts kits and L709 Axle set).

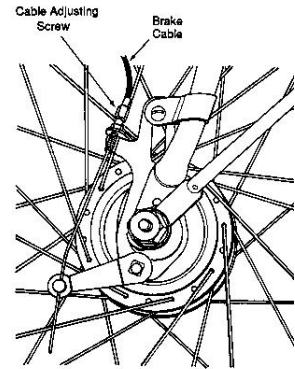

Coaster Brake (if applicable): Foot activated coaster brakes are easy to use and reliable. To activate this internal brake, reverse the pedaling motion until the brake engages. To avoid skidding and maintain control, apply care when braking. This is especially true on wet surfaces. Apply brakes gently, gradually increasing pedal back pressure. Replace coaster brakes when they become worn. Check chain tension regularly.

Tires: Always check for worn or damaged tires. The Worksmen Sup-r-tires are heavy duty. We recommend 40PSI as proper level of inflation. Replace tires that are worn or cut immediately. Replace tubes that show leaks.

RULES FOR SAFE RIDING AND RESPONSIBLE OPERATION: Carefully read this manual before operating the cycle.

- It is the responsibility of the person who completes the assembly to properly install all parts included and to inspect the cycle prior to riding to insure proper operation.
- Operator is responsible for required maintenance to keep the cycle in good operation condition
- Observe all traffic regulations in the operating environment (stop signs, etc.)
- Keep to the right and in a straight line. Ride in single file.
- Do not ride outdoors, at night
- Have appropriate signaling device as needed (we recommend the 3973 Mega Horn)
- Give Pedestrians the Right of Way
- Always look around you to understand the riding environment and hazards.
- Do not carry passengers
- Check brakes prior to riding
- Slow down when approaching turns or intersections. Tricycles are meant for slow pace rides, not for racing.
- Use proper hand signals when turning or stopping
- Recommended Safety Options: Approved helmet, audible warning device.
- Never ride the cycle if there are known repairs required.
- Do not exceed the recommended weight capacity of the cycle
- Place loads evenly on platform. Do not stack cargo too high. Secure cargo with appropriate tie down straps.
- Wipe surface of cycle clean and dry when exposed to corrosive substances or environment.
- Operate Cycle at slow speeds, particularly in high traffic areas
- Operators of cycles should be in good physical condition. Ride at your own risk.
- Wear proper riding attire. Check shoelaces so they do not become tangled in the chain and sprocket.
- Ride only on smooth, paved surfaces. Do not use off road.
- Do not operate a tricycle on steep grades. They are designed for relatively level, paved surfaces only
- Always replace worn parts with genuine Worksmen Cycle Repair Parts.
- Always keep both hands on the handlebars. Tricycles have a tendency to pull slightly to one side.

LIMITED WARRANTY:

THIS CYCLE IS WARRANTED AGAINST FAULTY PARTS UNER THE FOLLOWING CONDITIONS: THIS WARRANTY DOES NOT COVER ANY FAILURE DUE TO ACCIDENT, ABUSE, MISUSE, NEGLIGENCE OR AS THE RESULT OF NORMAL WEAR AND TEAR, OR IMPROPER ASSEMBLY. THE ENTIRE FRAME INCLUDING ALL WELDED JOINTS IS WARRANTED TO BE FREE FROM DEFECTS AND MATERIAL FOR ONE YEAR WHILE IN POSSESSION OF THE ORIGINAL PURCHASER. ALL OTHER PARTS ON THIS CYCLE EXCEPT TIRES AND TUBES IS WARRANTED FOR NINETY DAYS FROM THE DATE OF PURCHASE. REPAIR AND REPLACEMENT OF THESE PARTS IS TO BE ACCORDING THE WORKSMAN CYCLES PARTS AND SERVICE PROCEDURES AND MUST BE HANDLED DIRECTLY THROUGH THE SOURCE WHERE THE CYCLE WAS PURCHASED. IF UPON EXAMINATION OF THE PARTS IN QUESTION, THE WORKSMAN CYCLE DEALER DETERMINES THAT IT IS DEFECTIVE, EITHER REPAIR OR REPLACEMENT WILL BE MADE AT NO COST EXCEPT THE COST OF TRANSPORTATION AND LABOR CHARGES (IF ANY). UNAUTHORIZED REPAIRS OR REPLACEMENT AUTOMATICALLY VOIDS WARRANTY. PROPER MAINTENANCE IS REQUIRED FOR WARRANTY TO BE VALID. IN THE EVENT THAT IT WAS DETERMINED THAT THE WARRANTY CLAIM IS THE RESULT OF MISUSE, ABUSE, IMPROPER MAINTENANCE OR SIMPLY NOT DEFECTIVE OR BEYOND THE WARRANTY PERIOD, WORKSMAN CYCLES OR THE DEALER WILL ADVISE YOU AS TO THE COST OF REPAIR, REPLACEMENT OR LABOR PRIOR TO PERFORMING ANY WORK OR REPLACING ANY PARTS. IF YOU CHOSE NOT TO HAVE THE DEALER OR WORKSMAN CYCLES PERFORM THE WORK, THE PARTS WILL BE RETURNED TO YOU AT YOUR EXPENSE OR DISCARDED IF NO REPLY IS RECEIVED WITHIN 2 WEEKS OF NOTICIATION. THE SOLE RESPONSIBILITY OF THE MANUFACTURER TO THE TERMS OF THIS WEARRANTY, IF ANY, SHALL BE THE REPAIR AND OR REPLACEMENT OF THE PARTS AS INDICATED ABOVE. THE LIABILITY OF THE MANUFACTURER SHALL IN NO EVENT EXCEED THE ORIGINAL PURCHASE PRICE OF THE PRODUCT AND THE MANUFACTURER SHALL NOT BE RESPONSIBLE FOR ANY CONSEQUENTIAL DAMAGES OF ANY NATURE, INCLUDING, BUT NOT BY WAY OF LIMITATION, DAMAGES FOR PERSONAL INJURY OR PROPERTY. THIS STATEMENT CONSTITUTES THE EXCLUSIVE EXPRESSION OF WARRANTIES BY THE MANUFACTURER AND IS IN LIEU OF ANY OR ALL OTHER WARRANTIES SUCH AS EXPRESSED WARRANTIES, IMPLIED WARRANTIES, INCLUDING BUT NOT LIMITED TO WARRANTIES OF MERCHANTABILITY, AND FITNESS OR PURPOSE., ARE LIMITED IN DURATION FOR ONE YEAR FROM THE DATE OF PURCHASE O THE FRAME ONLY AND 90 DAYS FOR ALL OTHER PARTS, EXEPT TIRES AND TUBES WHICH ARE NOT WARRANTED. WORKSMAN TRADING CORPORATION IS THE MANUFACTURER. MISUSE OF THE CYCLES INCLUDING OFF ROAD RIDING, INSTALLATION OF MOTORS OR POWER ASSISTS, ALTERATIONS, REPAIRS USING PARTS OTHER THAN GENUINE WORKSMAN CYCLE PARTS VOIDS WARRANTY. WORKSMAN TRADING CORPORATION IS NOT RESPONSIBLE FOR MAINTAINING RECORDS OF SERIAL NUMBERS. VOID WHERE PROHIBITED BY STATE LAW.

FAX THIS COMPLETED REGISTRATION FORM TO 718 529 4803

Name of Purchaser _____ Company Name _____
Mailing Address _____
Tel _____ Fax _____ e-mail _____
Date of Purchase _____ Dealer name _____
Serial Number (located under crank housing) _____ Color _____

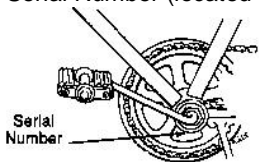

NOTES _____

SIGNATURE _____ DATE _____

FAX THIS COMPLETED FORM TO 718 529 4803- RETAIN COPY FOR YOUR RECORDS.